

INSTALLATION INSTRUCTIONS

HOUSEHOLD PEG•IT 21" WOODEN STORAGE RACK

Parts List	Qty
(A) 21" WOOD RAIL/RAIL DE MADERA DE 53.34CM/BARRE EN BOIS DE 53.34CM	1
(B) OVER-THE-DOOR BRACKETS/LAS ABRAZADERAS DE LA PUERTA /LES SUPPORTS POUR LE DESSUS DE PORTE	2
(C) BRACKET EXTENDERS/EXTENSIONES DE LAS ABRAZADERAS/LES ALLONGES DE SUPPORT	2
(D) LONG FLATHEAD SCREWS/TORNILLOS LARGOS DE CABEZA PLANA/LES LONGUES VIS À TÊTE CONIQUE	2
(E) SHORT SCREWS/TORNILLOS CORTOS/LES VIS COURTES	4
(F) SCREW COVERS/CUBIERTAS PARA TORNILLOS/LES COUVRE-VIS	2

MOUNTING INSTRUCTIONS

Note: The narrow edge of the wood rail is always at the top.

OVER-THE-DOOR MOUNT:

Tools needed: Phillips screwdriver and a level

Over-the-door brackets (B) fit any hollow or solid standard 1-3/8" interior door.

1. Position over-the-door brackets (B) over predrilled holes on back of wood rail (A) and fasten with short screws (E). Figure 1
2. Press screw covers (F) over screw holes on front of rail. Figure 2
3. Place assembled Peg•It Wood Hanger over door.

If the door is slightly smaller than 1-3/8", you can create a cardboard shim using the template below and glue the shims to the inside of the over-the-door brackets for a tighter fit (as shown in Figure 3).

WALL MOUNT: Figure 4

Tools needed: A drill with 1/8" drill bit, Phillips screwdriver and a level

Note: We recommend mounting the rail to at least one wall stud. The metal brackets are not required for this type of mounting.

1. Locate studs.
2. Position wood rail (A) so mounting holes line up with wall studs.
3. Level rail on wall. Mark holes and drill a 1/8" pilot hole at each location.
4. Mount rail to wall with long flathead screws (D)
5. Press screw covers (F) over screw holes on front of rail. Figure 2

OFFICE CUBICLE MOUNT:

Tools needed: Phillips screwdriver and a level

By using brackets (B) and bracket extenders (C), the Peg•It Wood Hanger can be mounted over cubicle walls 1-3/8", 1-3/4", 2-1/4" and 2-3/4".

TO MOUNT OVER CUBICLE WALLS 1-3/8" WIDE OR LESS:

Follow same instructions for mounting over the door. If the cubicle wall is slightly smaller than 1-3/8", you can create a cardboard shim using the template below and glue the shims (as shown in Figure 3) to the inside of the over-the-door brackets (B) for a better fit.

TO MOUNT OVER CUBICLE WALLS WIDER THAN 1-3/8":

1. Before mounting over-the-door brackets (B) to wood rail (A), snap off the short end of the bracket by bending it up and down a few times (as shown in Figure 3). This can be done by hand or with a pair of pliers.
2. Position over-the-door brackets (B) over predrilled holes on back of wood rail (A) and fasten with short screws (E).
3. Press screw covers (F) over screw holes on front of rail. Figure 2
4. Determine the width of the cubicle wall and hook brackets (B) and bracket extenders (C) together as shown in Figure 3A. Be sure they are pulled tightly together.
5. Place assembled Peg•It Wood Hanger over cubicle wall.

If the cubicle wall is slightly smaller than bracket opening, you can create a cardboard shim using the template below and glue the shims (as shown in Figure 3) to the inside of the over-the-door brackets (B) for a tighter fit.

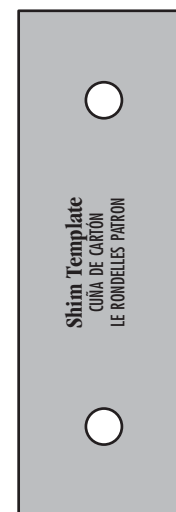
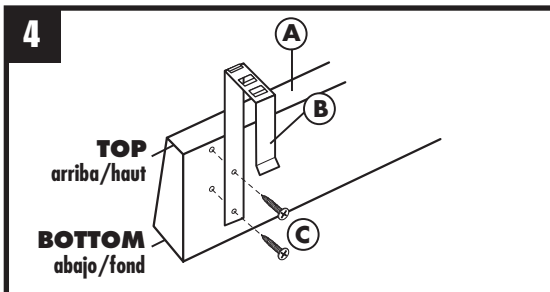
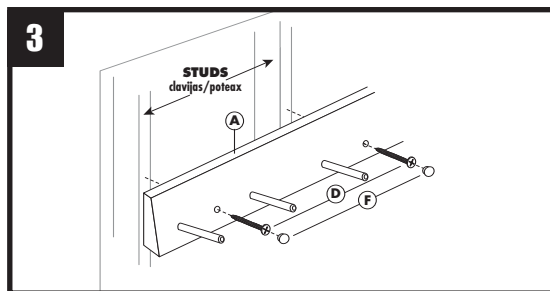
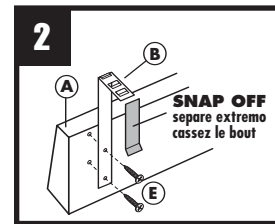
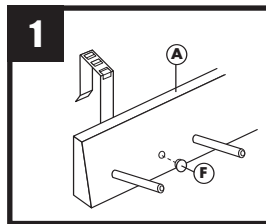

CRAWFORD®

Made in/Hecho en/Fait au China
 For/Para/Pour The Lehigh Group, Macungie, PA 18062
 Canada: Royal International Corp., Montréal QC H4T1T9
 www.lehighgroup.com